

SPECIFICATION

IMAGE FORMAT	1/2"
FOCAL LENGTH(mm)	1.55
F.O.V.	192°(D)
	192°(H)
	180°(V)
RESOLUTION	8 MP
DISTORTION	100%
APERTURE	3.0
MOUNT(mm)	M12x0.5
IRIS	Fixed
M.O.D.(mm)	0.1
T.T.L.(mm)	30.5
DIMENSION(mm)	Φ32x27.5
LENS COMPONENT	8G + 1IR

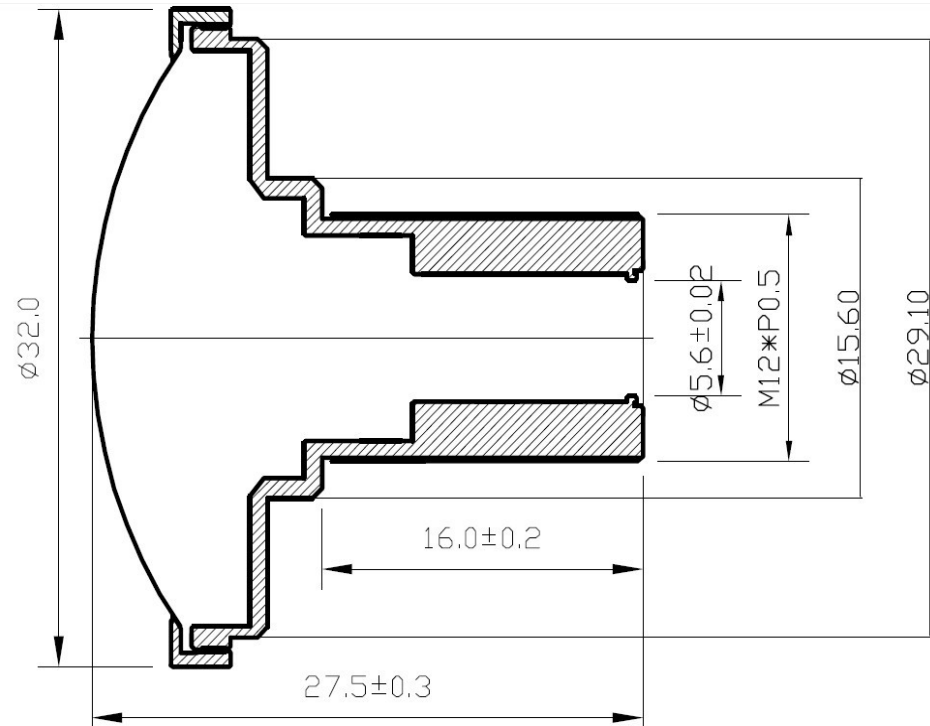

SCALE	4:1	DRAWN		MODEL	CCL120155MPF	REV	DESCRIPTION	DATE	NAME
DATE		CHECK		 香港致远电子集团有限公司 HONGKONG TOWIN ELECTRONICS CO.,LTD.		①			
UNIT	mm	APPROVE				②			
						③			